

Samsung Galaxy Xcover 4

How to insert your sim card;

Remove the back cover and battery.

Insert the SIM or USIM card with the gold-coloured contacts facing downwards.

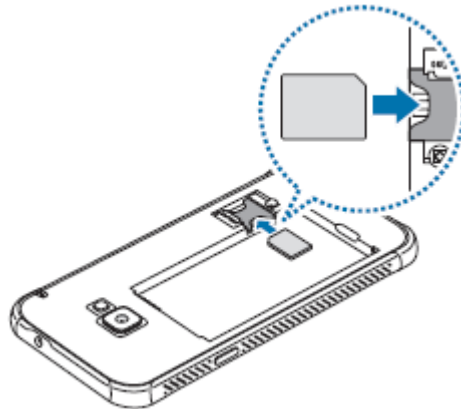

If you needed a new sim card, you will have received a triple sim card pack. You'll need to pop out the appropriate sim card that is needed for your Samsung Galaxy Xcover 4.



Mini-SIM



Micro SIM



Nano Sim

Samsung Galaxy Xcover 4 uses a Micro sim card.